



**CENTA GROUP**  
COMPLETE FIRE PROTECTION

#### INSPECTION & MAINTENANCE:

Occupational Health and Safety (OSH Act) requires that all fire extinguishers are maintained in accordance with the Manufacturers specifications and **SABS 1475**.

**INSPECTION** is a quick test to ascertain that the fire extinguisher is working. Check the discharge hose to ensure that the unit has not been discharged, there is no obstruction of the discharge device and that the gauge is showing pressure. Use a pressure tester to check that the pressure in the cylinder is as per the stated specifications.

**MAINTENANCE** of **CENTA** Fire extinguishers must be carried out in accordance with the procedures as laid out in **SABS 1475**.

#### SERVICING PROCEDURE:

Servicing **CENTA** products may only be undertaken by registered **SAQCC-Fire 1475** competent persons, who are employed by an **SABS 1475** approved company. Servicing and maintenance intervals must comply with **SABS 1475**.

#### SERVICING TIPS:

1. Before servicing a fire extinguisher ensure the unit is not pressurized by partially releasing the pressure relief valve. A 'hissing sound' indicates pressure which must be released before working on the unit.  
(NOTE: Check for pressure regardless of gauge reading)
2. It is dangerous to 'break / unscrew' the valve, as a valve thread release may not be present.
3. Prevent leakage and preserve the 'O' Ring by lightly greasing the cylinder neck and valve neck 'O' Ring.
4. When refitting a valve to a cylinder always replace the valve neck 'O' Ring.
5. Use a light solvent to clean all parts of the valve.  
Do not grease valve stem 'O' ring.

#### WARNING:

Only pressurized stored pressure extinguishers with dry nitrogen from a cylinder with a regulator set at no greater than 1500kpa. Never pressurize without a regulator.

#### TOOL REQUIREMENTS:

The following tools will assist in the productive servicing of **CENTA** fire extinguishers:

- **CENTA** valve spanner
- No 10 spanner removes pressure relief nut
- No 14 spanner removes nozzle
- No 22 spanner removes gauge
- Light hammer removes valve handle pin

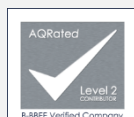

# FIRE EXTINGUISHER

**9.0 Kg D-CLASS (AA0910F)**



#### SPECIFICATIONS:

Height (mm):	540
Diameter (mm):	175
Mass Empty (kg):	5.10
Mass Full (kg):	14.10
Medium:	D Class Powder
Charge (kg):	9
Discharge distance (m):	2
Working pressure (kPa):	800
Paint coating:	Heavy Duty Powder Coating

#### CENTA HEAD OFFICE:

Unit 5, 3 Sasswood Road, Glen Anil, Durban North, SA  
CALL: 0860 10 20 41 EMAIL: [centa@centa.co.za](mailto:centa@centa.co.za)

[WWW.CENTA.CO.ZA](http://WWW.CENTA.CO.ZA)

# EXPLODED VIEW

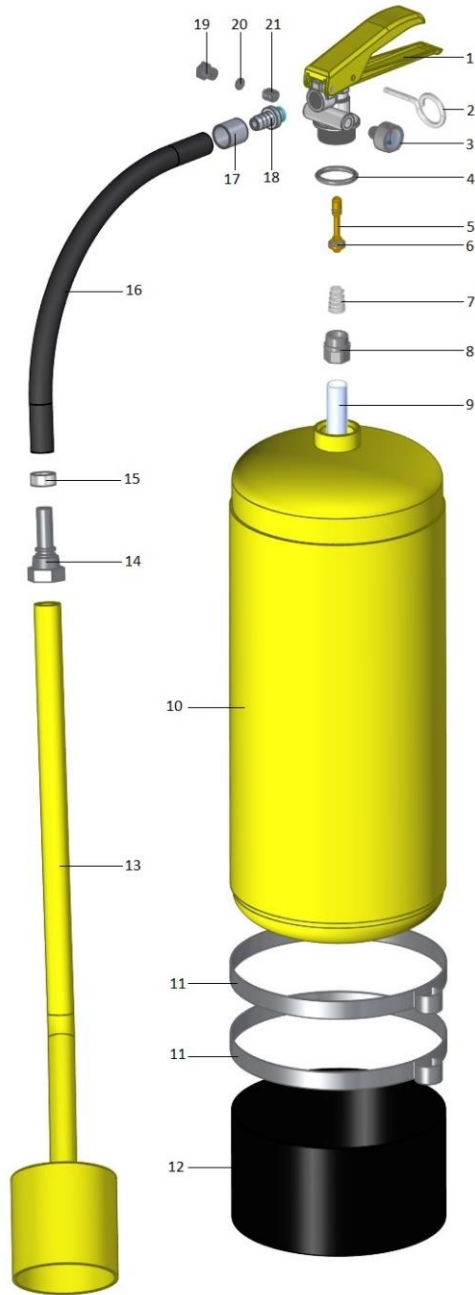

# CENTA GROUP

COMPLETE FIRE PROTECTION

1	Valve Assembly
2	Safety Pin
3	Pressure Gauge
4	O-Ring
5	Plunger
6	O-Ring
7	Plunger Spring
8	Siphon Tube Holder
9	Siphon Tube
10	Cylinder
11	Stainless Steel Hose Holder
12	Base
13	Nozzle
14	Hose Connector
15	Crimp
16	Hose
17	Crimp
18	Hose Connector
19	Relief Valve Nut
20	Relief Valve Sealing Cap
21	Relief Valve Spring

## TROUBLESHOOTING GUIDE

### **WARNING:**

DO NOT service an extinguisher until ALL internal pressure has been released. It is advisable to determine leaks before releasing the pressure.

PROBLEM	CORRECTIVE ACTION
<b>UNIT LOOSING PRESSURE</b>	CHECK: <ul style="list-style-type: none"> <li>•Cylinder for pin hole leak</li> <li>•Valve for leak</li> <li>•Neck 'O' ring joint for leak</li> </ul>
<b>VALVE LEAK</b>	CHECK VALVE STEM: <ul style="list-style-type: none"> <li>•'O' ring is clean and has not been cut.</li> <li>•Chamber is clean.</li> </ul>
<b>GAUGE THREAD LEAK</b>	Remove gauge, and reinstall using loctite or thread tape on the gauge thread. Clean 'O' Ring on valve.
<b>NECK 'O' RING LEAK</b>	Remove valve. Ensure neck ring area is free of dirt. Remove excess paint. Replace valve neck 'O' Ring. Grease the neck and neck 'O' Ring. Replace the valve.
<b>DEFECTIVE GAUGE</b>	Excessive shock can damage gauges. If damaged, remove gauge and replace.
<b>CYLINDER LEAK</b>	CENTA units carry a conditional warranty. If the unit is under 3 years old and in a good condition, the cylinder will be replaced.

## EXTINGUISHER MAINTENANCE INTERVALS

TYPE	CONTAINER MATERIAL	STORED PRESSURE OPERATION	MAINTENANCE INTERVALS	
			MAINTENANCE (years)	INTERNAL INSPECTION & PRESSURE TEST (years)
Dry powder	MS	SP	1	5
	SS	SP	1	5
Water	MS	SP	1	5
	SS	SP	1	5
Foam	MS	SP	1	5
	SS	SP	1	5
CO2	AL	SP	1	10 *
	CrMo	SP	1	10 *